

66 West End · Redruth · Cornwall · TR15 2SQ

t: 01209 210333

e: bill@billbannister.co.uk · www.billbannister.co.uk

BILL BANNISTER

Sales & Lettings



9 Chili Road

Illogan Highway, Redruth, TR15 3JT

£265,000



Situated in a popular residential location, this very well presented semi detached house benefits from a larger than average landscaped rear garden. The property benefits from a lounge with an open plan day room/kitchen/diner, a useful utility area and a bathroom. It has gas fired heating, is double glazed and has the bonus of paved parking to the front for two vehicles.



This lovely semi detached house was recently renovated by the previous owners and the current vendors have enhanced the property by landscaping the rear garden and block paving the front of the property providing parking for two vehicles. The property itself benefits from two bedrooms, a lovely open plan day room/kitchen/diner, a separate lounge and a family bathroom. It is double glazed and this is complemented by gas central heating. This is a superb property with a larger than average rear garden and a viewing is highly recommended.

Decorative glazed door to:

HALLWAY

Radiator.

LOUNGE

8'7" x 11'7" (2.64m x 3.54m)

Decorative feature fireplace and hearth with a recess either side having shelving and cupboards below. Window to the front and a radiator.

BATHROOM

5'3" x 9'7" (1.62m x 2.94m)

P shaped panelled bath with a wall mounted shower, tiled surround and a shower curtain. Wash hand basin with a vanity unit below and a tiled splash back. WC with a push button flush. Stainless steel heated towel rail. There is a further recessed area with shelving and a built-in cupboard housing a Vaillant gas boiler. Tiled floor, obscure glazed window to the front with a deep sill and an Envirovent extractor.

OPEN PLAN DAY ROOM/KITCHEN/DINER

DAY ROOM

11'10" x 12'5" (3.63m x 3.80m)

Stairs to the first floor, feature fireplace with a stone hearth and feature electric fire with feature stone wall over. Recess to either side with built-in cupboards, one of which contains the consumer unit. Radiator.

KITCHEN/DINER

14'4" x 8'6" (4.39m x 2.60m)

The dining area has a Velux window, recessed lighting and upvc French doors leading to the rear garden. The kitchen area is fitted with a range of eye level and base units with roll edge work surfaces and part tiled splash backs. Stainless steel sink and drainer, Beko single oven and ceramic hob with a glass splash back and extractor fan. Velux window, recessed lighting and a step to the utility room with a window to the side elevation.

UTILITY AREA

5'0" x 12'11" (1.54m x 3.95m)

With a range of base units and an integrated dishwasher. One and a half bowl stainless steel sink unit and drainer. Tiled splash back and roll edge work surface. Space and plumbing for white goods, Velux window, recessed lighting, radiator and an Envirovent extractor.

FIRST FLOOR

BEDROOM 1

13'4" x 12'0" (4.08m x 3.67m)

Window to the front, radiator and loft access.

BEDROOM 2

10'7" x 11'1" (3.25m x 3.38m)

Window to the rear, radiator and some built-in shelving.

OUTSIDE

To the front of the property there is block paving providing ample parking for two vehicles which is bordered by mature bushes and shrubs. The gas meter is at the front of the property. To the rear of the property the vendors have undergone substantial landscaping to incorporate lawned areas, flower beds and borders containing mature bushes and shrubs, a patio area, raised beds and a shed. The garden is well enclosed with a gated access.

DIRECTIONS

From our office in Redruth take the main road towards Camborne passing Camborne/Redruth Hospital and Taylors Tyres on the left hand side. Take the next turning right after the traffic lights into Chili Road and the property will be found on the left hand side.

AGENTS NOTE

TENURE: Freehold.

COUNCIL TAX BAND: B.

SERVICES

Mains drainage, mains metered water, mains electricity, mains gas gas heating.

Broadband highest available download speeds - Standard 6 Mbps, Ultrafast 1800 Mbps (sourced from Ofcom).

Mobile signal Indoors - EE Likely, Three Limited, O2 Limited, Vodafone Limited (sourced from Ofcom).

Area Map



Floor Plans

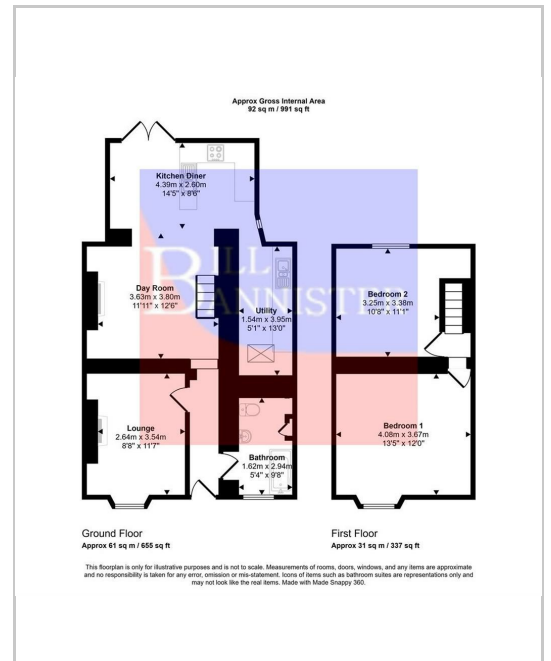

Energy Efficiency Graph

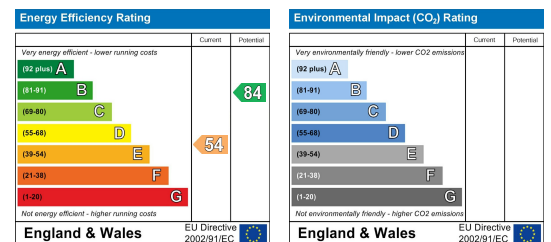

These particulars, whilst believed to be accurate are set out as a general outline only for guidance and do not constitute any part of an offer or contract. Intending purchasers should not rely on them as statements of representation of fact, but must satisfy themselves by inspection or otherwise as to their accuracy. No person in this firms employment has the authority to make or give any representation or warranty in respect of the property.